



imageFORMULA
P-208

Product Launch Information



Roadmap & Positioning

Positioning

Back in 2009, Canon launched the imageFORMULA P-150 as the fastest and most compact personal scanner, which has the unique function of plug-and-scan ability without the need to install TWAIN/ISIS drivers in the PC. Riding on the success of the P-150, we launched the imageFORMULA P-215 in 2011, which has card scanning capabilities, enhanced image processing functions and hybrid OS support.

Canon recognizes the increasing demand for document scanning and information processing on-the-go for mobile workers. As such, we launched the new imageFORMULA P-208, an ultra-compact portable scanner that allows users to perform ad-hoc scanning on the move.

Although it is compact in size, the P-208 incorporates many premium features such as Auto-Document Feeder, one-pass duplex scanning capability and supports the scanning of plastic cards. Paired with the optional Wi-Fi module WU10, the P-208 allows users to scan directly to iOS or Android devices with Canon's CaptureOnTouch Mobile application via a Wi-Fi network.

Product Highlights

Auto document feeder

While most mobile scanners in the market are single-fed (i.e. documents are fed sheet-by-sheet manually), the P-208 features an Auto Document Feeder which can load up to 10 sheets. In order to prevent documents set on the feeder tray from falling, the Paper Holding Guide gently pinches documents as soon as the documents are set on the Feeder tray.

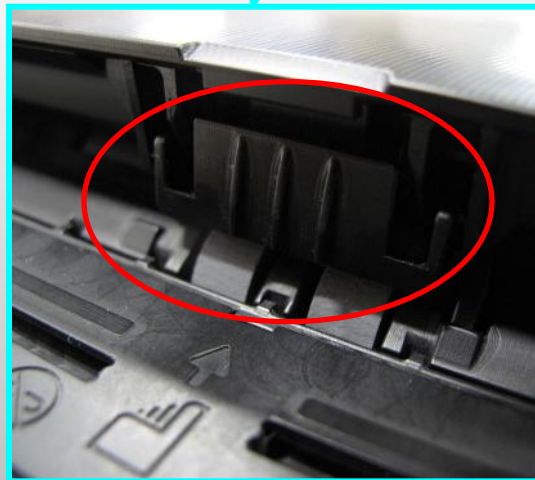

Paper Holding Guide

Product Highlights

One-pass duplex scanning

The P-208 incorporates 2 CIS sensors in its compact body to provide one-pass duplex scanning capability.

Card scanning

Even though it is a mobile scanner, the P-208 supports the scanning of plastic cards. The P-208 is also able to scan embossed card, but the card has to be placed faced-up.

Bus-powered drive

With the advanced power management technology, the P-208 can execute scanning by simply connecting to a PC with a single USB cable.

Note:

The P-208 does not require USB 3.0 for power and does not support USB 3.0 data transfer speeds. The scanner will work at USB 2.0 speeds even when it is connected USB 3.0 port.

Product Highlights

Scanning speeds

A4/ Portrait		Canon P-208**	Epson DS-30	Brother MDS-700D	Brother MDS-600	Fujitsu S1100**	Fujitsu S1300i**	Fujitsu S1300i***
200dpi	B&W	8ppm	4.6ppm	9.2ppm	5ppm	8ppm*	4ppm*	12ppm*
		16ipm	-	4.8ipm	-	-	4ipm*	12ipm*
	Color	8ppm	4.6ppm	3.1ppm	2.7ppm	8ppm	3ppm	9ppm
		16ipm	-	1.5ipm	-	-	3ipm	9ipm

* with B&W, 300 dpi

**Bus power drive (S1300i cannot work 1 USB but needs 2 USB cable)

***Needs AC adapter

CaptureOnTouch Lite (for Windows/Mac)

Unlike most scanners need to install specific device drivers and scanning applications onto PC to initiate scanning, the P-208, with its compact device driver and the CaptureOnTouch Lite embedded in the device, can scan without installing its Driver nor scanning application onto PC.

When the P-208 is connected to PC with USB cable with Auto Start Switch ON, the P-208 is recognized as a Removable Drive with the driver and the CaptureOnTouch Lite ready to run. When user starts this drive, the top screen of CaptureOnTouch Lite is displayed.

Product Highlights

CaptureOnTouch Lite (for Windows/Mac)

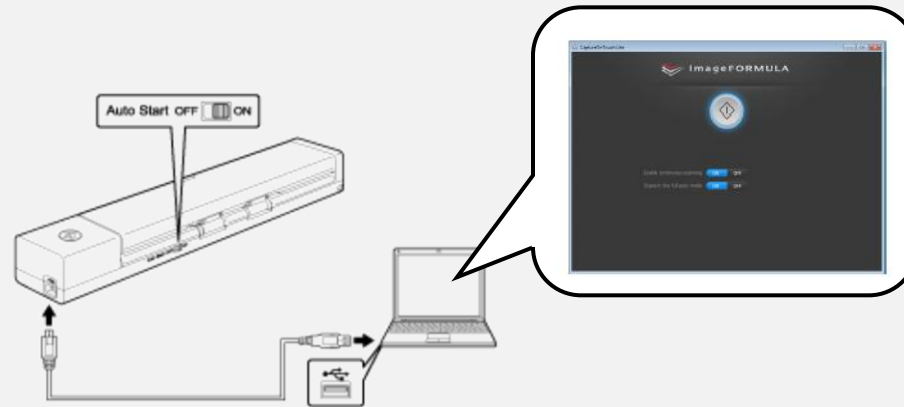

CaptureOnTouch Lite activates automatically only by connecting the P-208 to PC with USB cable with Auto Start Switch ON.

Note:

The method to start CaptureOnTouch Lite depends on OS and there would be a case that it may not run by just connecting the scanner to a PC. In this case, please open "ONTOUHLITE" driver from Windows explorer directly and activate CaptureOnTouch Lite by double clicking ONTOUHL.exe.

Product Highlights

Windows & Mac support

With the P-208, the drivers and CaptureOnTouch for Windows and for Mac are available in the Setup DVD-ROM.

Note: The P-208 supports the latest versions of Windows (Windows 8) and Mac (Mac OS 10.8 Mountain Lion).

Evernote Plug-in for Mac

User can select Evernote as output method directly if user installs Evernote plug-in into the Windows PC. In the past, with Mac OS, user needs 2 actions –select “Send to application” from the output methods and designate Evernote from the available application software. In order to provide easier and quicker operation, the Evernote plug-in for Mac is available so that user can send the scanned data to Evernote immediately after scanning, as the device acts with Google docs.

Product Highlights

Additional image processing function

The P-208 includes a new function “Apply corrections suitable for photographs”.

With our existing DR scanners, we have developed our image processing algorithm to optimize the reproduction of text information. As a consequence, output images tend to put emphasis on reproduction of Black and White to enhance readability of documents. However, output results may not be that ideal for originals containing photos or graphics.

As users may use the P-208 to scan photos or documents with graphics content, the additional image processing function “Apply corrections suitable for photographs” is to reproduce images close to the originals.

With “Apply corrections suitable for Photographs” ON



Standard (Default)



Note: Output results may vary for documents.

Product Highlights

Optional Wi-Fi battery box

The Wi-Fi battery box WU10, is available as an option for the P-208. With this WU10 connected to the P-208, users are able to operate the P-208 via Wi-Fi communication from Wi-Fi-ready devices. The WU10 will also serve as a power outlet for the P-208.

The WU10 works on two different Wireless connection modes, Access Point mode and Station mode. With Access Point mode, the scanner itself acts as Access Point to establish one-to-one direct communication with Wi-Fi ready PC, iOS or Android devices. While with Station mode, the WU10 communicates with Wi-Fi ready PC, iOS or Android devices via access point installed in a network environment.



P-208 with WU10 attached

The free simple and easy-to-use application, CaptureOnTouch Mobile, for iOS and Android devices will be available for download on Google Play and Apple iTunes stores.

Product Highlights

Supported Functions

Many image processing functions from the current DR scanner series are available on the P-208:

	Item	Support	Note
Software (ISIS/TWAINDrivers)	De-skew	Y	Processed by Driver. De-skew with angle & contents of fed documents is added
	Auto size detection	Y	Processed by Driver.
	3-dimensional color correction	Y	Processed by Driver.
	User Preference	Y	
	Color Dropout	N/A	
	Auto Color Detection	Y	Supporting Gray mode.
	Shading correction	Y	Processed by the Driver before batch.
	Text Enhancement	Y	Advanced Text Enhancement II
	High-speed text enhancement	N/A	
	Multi Stream	N/A	
	Preset Gamma Curve	Y	Can be loaded in each setting of the front and back, and Gray/ RGB.
	Scan Panel	Y	Processed by Driver.
	Black Border Removal	N/A	Unnecessary function with the P-208 since the background color is white.
	Pre-scan	Y	
	Rotate image	Y	
	Skip Blank Page	Y	
	Select scanning document side	Y	
	Folio	N/A	
	Scan Area Setting	Y	
	Add-on	N/A	
	Text Orientation	Y	
	Punch Hole Removal	N/A	Unnecessary function with the P-208 since the background color is white.
Continuous Scanning	Y		
Edge Enhancement	5 steps		

Product Highlights

Supported Functions

	Item	Support	Note
Software (ISIS/TWAINDrivers)	Moiré Reduction	Y	Can select high-speed/ high-quality mode in less than 300dpi. High-quality mode is only available in 300dpi.
	Prevent Bleed Through / Remove Background	Y	
	Contrast arrangement	7 steps	
	Color Shift Correction	Y	
	Adding black margin mode	N/A	
	Area setting in double feed detection	N/A	
	Output barcode log data	N/A	
	Job function	Y	10 JOBS are available with CaptureOnTouch
	Background smoothing	Y	
	Shadow cropping	Y	
	Automatic setting of resolution	Y	
	Reduction ratio Adjustment	N/A	
	Apply corrections suitable for Photographs	Y	NEW
Hardware/ Option	Imprinter	N/A	
	High-speed JPEG transfer	N/A	
	Barcode Decoder	N/A	
	Staple Detection	N/A	
	Patch code	N/A	
	Double Feed Detection	Y	Detects by length
	Skew Detection	N/A	

Product Highlights

ISIS/TWAIN

The P-208 supports standard ISIS/ TWAIN drivers which can be used with various software in the market. The TWAIN version is 2.0.

Linux support

Linux support will be made available at a later date.

Bundled software

The bundled software for P-208 is as follows:

Driver		Software					
ISIS/ TWAIN (Win)	TWAIN (Mac)	Plug-in (Win/Mac)	Canon	3 rd party-made			
			Capture OnTouch/CaptureOnTouch Lite (Win/Mac)	PDF	Filing	Business card	Others
Yes	Yes	Evernote SharePoint Google docs	Yes	N/A	N/A	BizCard (Win/Mac)	N/A

Product Specifications

Type	Desktop sheetfed scanner	
Scanning Document Size		
Plain paper	Width	50.8 to 216 mm (2 to 8.5")
	Length	70 to 356 mm (2.756 to 14")
	Thickness (density)	52 to 209 g/m ² (14 to 55 lb bond) Thickness 0.06 to 0.22 mm (0.0024 to 0.0087")
Postcard	Width	88.9 to 108 mm (3.5 to 4.25")
	Length	127 to 152.4 mm (5 to 6")
	Thickness (density)	128 to 300 g/m ² (34 to 80 lb bond) Thickness 0.15 to 0.4 mm (0.0059 to 0.0157")
Business card	Width	49 to 55 mm (1.93 to 2.17")
	Length	85 to 91 mm (3.35 to 3.58")
	Thickness (density)	128 to 225 g/m ² (34 to 58 lb bond) Thickness 0.15 to 0.3 mm (0.0059 to 0.0177")
Card (ISO/IEC compliant)	Width	86 mm (3.39")
	Length	54 mm (2.13")
	Thickness	0.76 mm (0.03") or less Up to 1.4 mm (0.055") for embossed cards
Document Feeding Method	Automatic	
Scanning Sensor	Contact image sensor	
Light source	LED	
Scanning Side	Simplex/Duplex	
Scanning modes	Black and White, Error Diffusion, 256-level Grayscale, Advanced Text Enhancement II, 24-bit Color	
Scanning resolution	150 x 150dpi/200 x 200dpi/300 x 300dpi/ 400 x 400dpi/600 x 600dpi	

Product Specifications

Scanning Speed (Conditions: Core 2 Duo 2.53GHz CPU, 2 GB memory, A4 document size)		
When using USB 2.0 bus power:		
Grayscale	Simplex	200 x 200 dpi 8 pages/min. 300 x 300 dpi 8 pages/min.
	Duplex	200 x 200 dpi 16 images/min. 300 x 300 dpi 16 images/min.
24-bit Color	Simplex	200 x 200 dpi 8 pages/min. 300 x 300 dpi 6 pages/min.
	Duplex	200 x 200 dpi 8 images/min. 300 x 300 dpi 6 images/min.
* Power consumption on the scanner may fluctuate depending on the type of document being scanned, the processing load on the scanner, or the condition of your PC. In such cases, the scanning speed may vary.		
Interface	Hi-Speed USB 2.0	
External Dimensions (WxDxH)		
Document feed tray closed:	312.5 x 55.5 x 40 mm (12.30 x 2.19 x 1.54")	
Document feed tray open:	312.5 x 75.5 x 40 mm (12.30 x 2.97 x 1.54")	
Weight	Approximately 600 g (1.3 lb)	
Power Supply	Supply from USB (500mA / 5V)	
Power Consumption		
When connecting with USB cable		
		2.5 W
	In the Sleep mode:	1.5 W
	Power OFF	0.5 W or less
Noise	Not more than 56 dB	
Operating Environment	Temperature: 10°C to 32.5°C (50°F to 90.5°F) Humidity: 25% to 80% RH	
Suggested Daily Volume**	Approx. 100 sheets per a day	

* The specifications are subject to change without notice.

** This is calculated based on scanning speed and an assumed daily time of use.

Appendix

Product configuration

Item	P-208 EN Model
Main Body	Yes
USB Cable	Yes
Setup DVD-ROM	Yes
Setup Guide (EFS)	Yes
Supplement for Auto Start (JEFIGSDCK)	Yes

Note:

- *The P-208 main body is kept in a safekeeping bag (non-woven in material) in the package.*
- *Setup DVD-ROM includes Driver, CaptureOnTouch, Plug-in, EMC Cloud Capture, Manual data and 3rd Party-made Application Software (For Evernote, Installer is NOT bundled with the P-208. The download link for Evernote will be displayed on screen during the installation.)*
- *Supported languages with Driver and CaptureOnTouch:*
Windows: JP/EN/FR/IT/GE/SP/DU/RU/SC/TC/KR/TH/VE/PO
Mac: JP/EN/FR/IT/GE/SP/DU/RU/SC/TC/KR/PO

Appendix

Consumables

Separation Pad:

- It is advised that users exchange the separation pad when they start to experience feeding issues, such as double feed. (no recommended replacement cycle)

Options

1. Wi-Fi Battery Box WU10
2. Carrying case

Appendix

System Requirements

Our software requires the following system environment.

1. Operating System:

- Microsoft Windows XP Professional x32 (SP3 or later) & x64 Edition (SP2 or later)
- Microsoft Windows XP Home x32 Edition (SP3 or later)
- Microsoft Windows Vista x32 & x64 Edition (SP2 or later)
- Microsoft Windows 7 x32 & x64 Edition (SP1 or later)*
- Microsoft Windows 8
- Mac OSX 10.6 - 10.8

**We do not support Windows RT and Windows Store Application .
Support for Linux OS will be available at a later date.*

2. Recommended Environment:

- CPU: Core2Duo 1.66GHz or more
- Memory: 1 GB or more
- Hard Disc: 3 GB or more of Disc space is necessary for installing the all application software
- Interface: Standard USB Port (Hi-Speed USB 2.0)**
- Monitor: 1024 × 768 (XGA) or more

*** We do NOT guarantee the all interfaces.*

Appendix

System Requirements

3. Minimum Requirement:

- CPU: Celeron 600MHz
- Memory: 512MB

**** If Recommended Environment for OS is more than this condition, Minimum Environment is depended on the condition.*

4. Either an ISIS or TWAIN compatible application software that works on one of the operating systems noted above.